



**BORNIC**

# ZTN-015 SERIES



**GATE VALVES**

# IN-LINE BRASS GATE VALVES

PREMIER FLOW CONTROL OFFERING



Brass Valves: Visual Index

## Table of Contents

Visual Index.....H2

Gate Valves.....H3-H12

Reliance Valves ZTN-001 Brass Gate Valves are used in water applications to allow fixtures, appliances or areas of a building to be isolated without the need for draining the whole system.

About Us.....H13



# GATE VALVES

## ZTN-015 SERIES

Brass Gate Valve  
Non rising stem

### Features & Benefits

Bornic gate valves offer the ultimate in dependable service wherever minimum pressure drop is important

- Non-rising stem design to minimise installation height
  - Full bore design to ensure minimal pressure drop
  - Adjustable gland packing for ease of maintenance
  - Material selection results in superior dezincification and corrosion resistance properties
- Conforms with BS EN12288:2010 and generally conforms with MSS SP 80.

### Materials

PART NO	MATERIAL	SIZES
Body	Brass BS EN 12165 CW602N	All
Bonnet	Brass BS EN 12165 CW602N	All
Stem	Brass BS EN 12165 CW602N	All
Packing Nut	Brass BS EN 12164 CW617N	All
Packing	PTFE	All
Stem Bush	Brass BS EN 12165 CW602N	All
Disc	Brass BS EN 12165 CW602N	All
Steel (Zinc Plated)	Aluminium	All
Handwheel Nut	Steel (Zinc Plated)	All

001



### Dimensions & Weights

SIZE (inch)	WEIGHT (kg)	A (mm)	B (mm)	C (mm)
1/4	0.27	46	75	45
3/8	0.26	46	75	45
1/2	0.269	50	78	52.5
3/4	0.384	54	84	52.5
1	0.593	62	105	65
1 1/4	0.844	71	111	70
1 1/2	1.266	77.5	130	78
2	1.881	87.5	153	92
2 1/2	4.37	96	219	121
3	6.4	105	259	121
4	19.7	162	366	203

### Dimensional Drawing

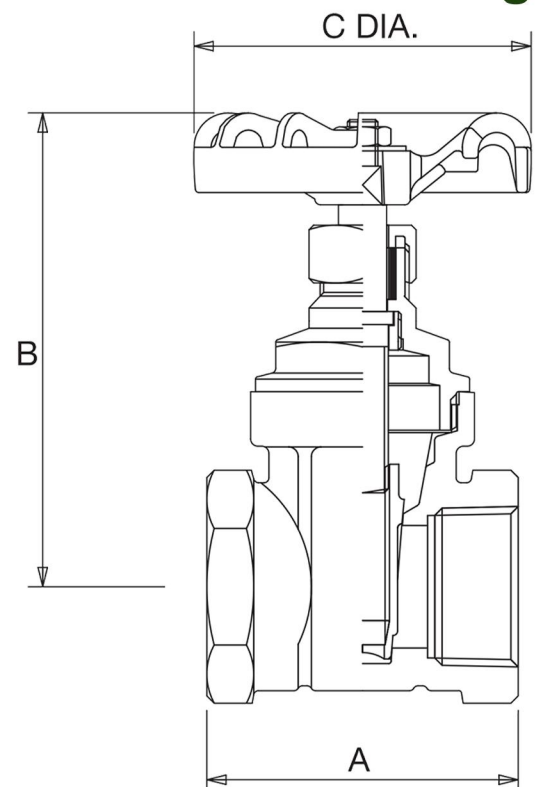

# GATE VALVES

## ZTN-015 SERIES

Brass Gate Valve  
Non rising stem

### Features & Benefits

WRAS approved for use on wholesome (potable) water insizes 1/2"-2"only.WRAS approval temperature 85°C max

Non-rising stem design to minimise installation height Full bore design to ensure minimal pressure drop

- Adjustable gland packing for ease of maintenance
- Body, bonnet and disc are made from low lead content brass, typically 4-6%
- Conforms with Bs EN12288:2010 and generally conforms with MSS SP 80.

### Materials

PART NO	MATERIAL	SIZES
Body	Brass BS EN 1982 CC491K	All
Bonnet	Brass BS EN 1982 CC491K	All
Stem	Brass BS EN 12164 CW602N	1/4 - 3
Stem	Manganese Bronze	4
Disc	Brass BS EN 12164 CW602N	All
Stem Retainer	Brass BS EN 12164 CW602N	1/2 - 2
Stuffing Box	Brass BS EN 12164 CW602N	1/4, 3/8, 21/2 & 3
Stuffing Box	Brass BS EN 1982 CC491K	4
Packing	Asbestos Free	All
Packing Gland	Brass BS EN 12164 CW614N	1/4, 3/8, 1 - 3
Packing Gland Nut	Brass BS EN 12164 CW614N	1/2 & 3/4
Packing Gland	Brass BS EN 1982 CC491K	4
Packing Nut	Brass BS EN 12164 CW614N	1/4 - 3
Packing Nut	Brass BS EN 1982 CC491K	4
Handwheel	Aluminium	1/4 - 3
Handwheel	Malleable Iron BS EN 1562 GJMB-300-6	4
ID Plate	Aluminium	All
Handwheel Nut	Brass BS EN 12164 CW614N	All
Gasket	Asbestos Free	3 - 4

### Dimensions & Weights

SIZE (inch)	WEIGHT (kg)	A (mm)	B (mm)	C (mm)
1/4	0.27	46	75	45
3/8	0.26	46	75	45
1/2	0.269	50	78	52.5
3/4	0.384	54	84	52.5
1	0.593	62	105	65
11/4	0.844	71	111	70
11/2	1.266	77.5	130	78
2	1.881	87.5	153	92
21/2	4.37	96	219	121
3	6.4	105	259	121
4	19.7	162	366	203

002



### Dimensional Drawing

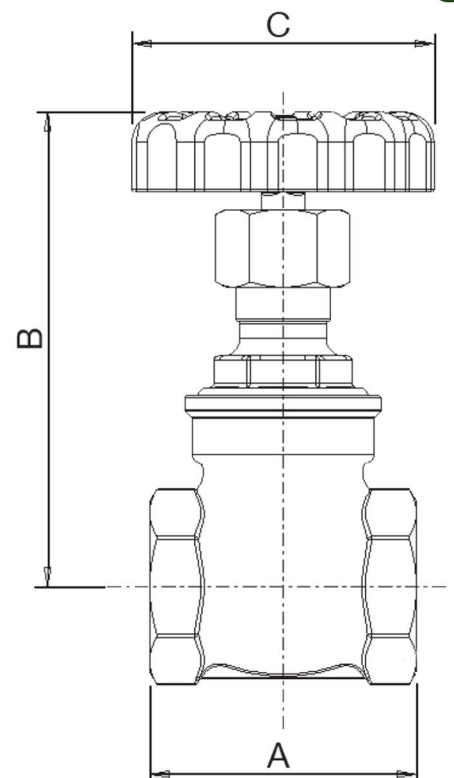

# GATE VALVES

## ZTN-015 SERIES

Brass Gate Valve  
Non rising stem

### Features & Benefits

- Non-rising stem design to minimise installation height
  - Full bore design to ensure minimal pressure drop
  - Adjustable gland packing forease of maintenance
  - Material selection results in superior dezincification and corrosion resistance properties
- Body, bonnet and disc are made from low lead content brass, typically 4-6%  
Conforms with BS EN12288:2010 and generally conforms with MSS SP 80.

### Materials

PART NO	MATERIAL	SPECIFICATION	SIZES
Body	Brass	BS EN 1982 (CC491K)	All
Bonnet	Brass	BS EN 1982 (CC491K)	All
Stem	Brass	BS EN 12164 CW602N	All
Disc	Brass	BS EN 1982 (CC491K)	All
Stem Retainer	Brass	BS EN 12164 CW602N	1/2 - 2
Stuffing Box	Brass	BS EN 12164 CW602N	1/4 - 3/8, 2 1/2 - 3
Packing Ring	PTFE	-	All
Packing Nut	Brass	BS EN 12164 CW614N	All
Packing Gland	Brass	BS EN 12164 CW614N	1/4 - 3/8, 1 - 3
Handwheel	Aluminium	-	All
Identification Plate	Aluminium	-	All
Handwheel Nut	Brass	BS EN 12164 CW614N	All
Gasket	Asbestos Free	-	3



### Dimensions & Weights

SIZE (inch)	WEIGHT (kg)	A (mm)	B (mm)	C (mm)	D (mm)	KV
1/4	0.27	46	75	45	86.7	-
3/8	0.26	46	75	45	86.7	-
1/2	0.27	50	78	52.3	93	21
3/4	0.38	54	84	60	103	39
1	0.59	62	105	65	127	66
1 1/4	0.89	71	111	70	139	116
1 1/2	1.31	77.5	130	78	163	162
2	2.09	87.5	153	92	193	281
2 1/2	5.62	106	235	103	286.2	411
3	7.89	113	251	121	310.3	635

### Dimensional Drawing

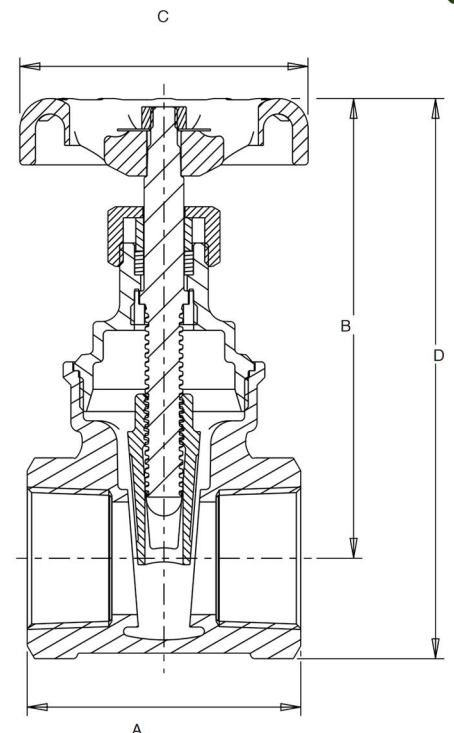

# GATE VALVES

## ZTN-015 SERIES

Brass Gate Valve  
Non rising stem

### Features & Benefits

- Robust and high quality brass body with integral seating surfaces
- Offers the ultimate in dependable service wherever minimum pressure drop is important
- WRAS approved for use with wholesome (potable) water
- Inside screw pattern with non-rising stem

### Materials

PART NO	MATERIAL
Body	Brass BS EN 1982 CC491K
Bonnet	Brass BS EN 1982 CC491K
Stem	Brass BS EN 12164 CW602N
Disc	Brass BS EN 1982 CC491K
Stem Retainer	DZR Brass BS EN 12164 CW602N
Packing Ring	Asbestos Free
Gland (28-54 only)	Brass BS EN 12164 CW614N
Packing Nut	Brass BS EN 12164 CW614N
Handwheel	Aluminium
Identification Plate	Aluminium
Handwheel Nut	Brass BS EN 12164 CW614N
Compression Olive	Brass BS EN 12449:1999 CW505L OR CW507L
Compression Nut	Brass BS EN 12165 CW617N



### Dimensions & Weights

SIZE (inch)	WEIGHT (kg)	A (mm)	B (mm)	C (mm)	D (mm)
15	0.34	69	74	53	26.5
22	0.50	75	86	59	23.5
28	0.70	86	105	65	25.5
35	0.95	100	110	70	30.5
42	1.45	111	131	78	34.5
54	2.50	133	152	93	37

### Dimensional Drawing

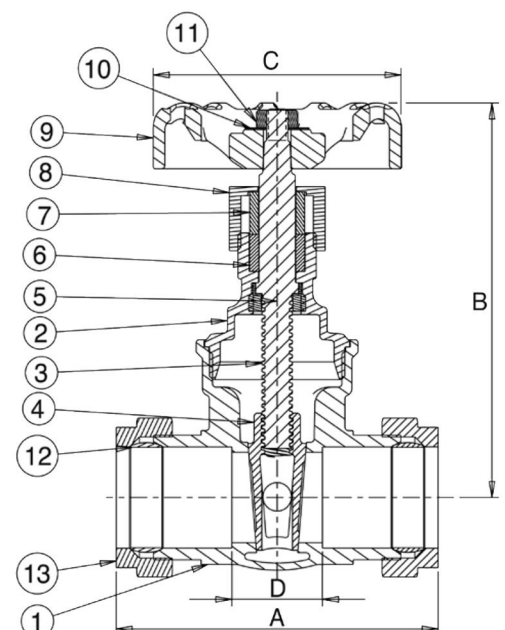

# GATE VALVES

## ZTN-015 SERIES

Brass Gate Valve  
Non rising stem

### Features & Benefits

- Bornic gate valves offer the ultimate in dependable service wherever minimum pressure drop is important

### Materials

PART NO	MATERIAL	SPECIFICATION	SIZES
Body	Brass	BS EN 1982 (CC491K)	All
Bonnet	Brass	BS EN 1982 (CC491K)	All
Stem	Brass	BS EN 12164 CW602N	All
Disc	Brass	BS EN 1982 (CC491K)	All
Stem Retainer	Brass	BS EN 12164 CW602N	1/2 - 2
Stuffing Box	Brass	BS EN 12164 CW602N	1/4 - 3/8, 2 1/2 - 3
Packing Ring	PTFE	-	All
Packing Nut	Brass	BS EN 12164 CW614N	All
Packing Gland	Brass	BS EN 12164 CW614N	1/4 - 3/8, 1 - 3
Handwheel	Aluminium	-	All
Identification Plate	Aluminium	-	All
Handwheel Nut	Brass	BS EN 12164 CW614N	All
Gasket	Asbestos Free	-	3

005



### Dimensions & Weights

SIZE (inch)	WEIGHT (kg)	A (mm)	B (mm)	C (mm)	D (mm)	KV
1/4	0.27	46	75	45	86.7	-
3/8	0.26	46	75	45	86.7	-
1/2	0.27	50	78	52.3	93	21
3/4	0.38	54	84	60	103	39
1	0.59	62	105	65	127	66
1 1/4	0.89	71	111	70	139	116
1 1/2	1.31	77.5	130	78	163	162
2	2.09	87.5	153	92	193	281
2 1/2	5.62	106	235	103	286.2	411
3	7.89	113	251	121	310.3	635

### Dimensional Drawing

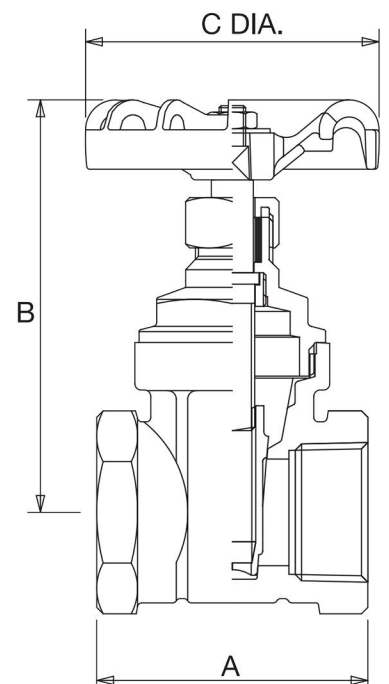

# GATE VALVES

## ZTN-015 SERIES

Brass Gate Valve  
Non rising stem

### Features & Benefits

Non-rising stem design to minimise installation height

· Full bore design to ensure minimal pressure drop

· Adjustable gland packing for ease of maintenance

· Material selection results in superior dezincification and corrosion resistance properties

Body, bonnet and disc are made from low lead content brass, typically 4-6%

### Materials

PART NO	MATERIAL	SPECIFICATION	SIZES
Body	Brass	BS EN 1982 (CC491K)	All
Bonnet	Brass	BS EN 1982 (CC491K)	All
Stem	Brass	BS EN 12164 CW602N	All
Disc	Brass	BS EN 1982 (CC491K)	All
Stem Retainer	Brass	BS EN 12164 CW602N	1/2 - 2
Stuffing Box	Brass	BS EN 12164 CW602N	1/4 - 3/8, 2 1/2 - 3
Packing Ring	PTFE	-	All
Packing Nut	Brass	BS EN 12164 CW614N	All
Packing Gland	Brass	BS EN 12164 CW614N	1/4 - 3/8, 1 - 3
Handwheel	Aluminium	-	All
Identification Plate	Aluminium	-	All
Handwheel Nut	Brass	BS EN 12164 CW614N	All
Gasket	Asbestos Free	-	3

006



### Dimensions & Weights

SIZE (inch)	A (mm)	B (mm)	C (mm)	D (mm)	WEIGHT (kg)	KV
1/4	46	75	45	86.7	0.36	-
3/8	46	75	45	86.7	0.36	-
1/2	50	78	52.3	93	0.27	21
3/4	54	84	60	103	0.38	39
1	62	105	65	127	0.59	66
1 1/4	71	111	70	139	0.84	116
1 1/2	77.5	130	78	163	1.31	162
2	87.5	153	92	193	2.09	281
2 1/2	105	232	103	283.2	5.62	411
3	111	264	121	323.3	7.89	635

### Dimensional Drawing

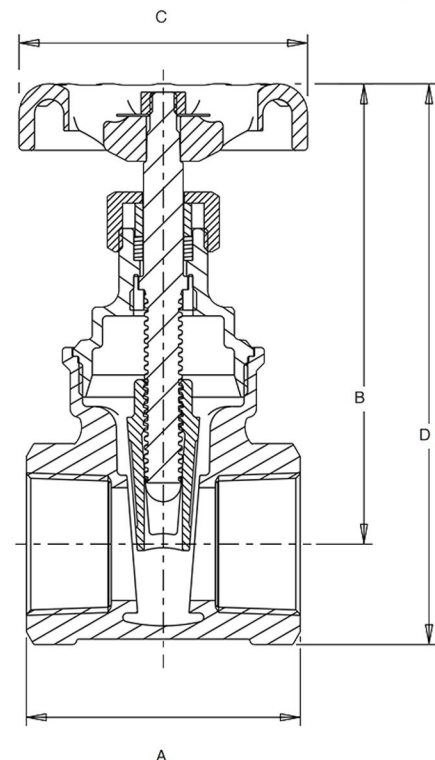



# GATE VALVES

## ZTN-015 SERIES

Brass Gate Valve  
Non rising stem

### Features & Benefits

- Bornic gate valves offer the ultimate in dependable service wherever minimum pressure drop is important

### Materials

PART NO	MATERIAL	SPECIFICATION	SIZES
Body	Brass	BS EN 1982 CC491K	All
Bonnet	Brass	BS EN 1982 CC491K	All
Stem	Brass	BS EN 1982 CC491K	1/4 - 2
Stem	Brass	BS EN 1982 CC491K	All
Disc	Asbestos Free	BS EN 1982 CC491K	All
Packing	Brass	-	All
Gland	Brass	BS EN 12164 CW614N	All
Packing Nut	Brass	BS EN 12164 CW614N	1/4 - 2
Packing Nut	Brass	BS EN 1982 CC491K	2 1/2 & 3
Handwheel	Aluminium	-	All
ID Plate	Aluminium	-	All
Handwheel Nut	Brass	BS EN 12164 CW614N	All



007

### Dimensions & Weights

SIZE (inch)	WEIGHT (kg)	A (mm)	B (mm)	C (mm)
1/4	0.32	46	126	45
3/8	0.31	46	126	45
1/2	0.46	51	129	52
3/4	0.72	55	159	65
1	1.1	63	189	70
1 1/4	1.5	71	219	78
1 1/2	2.25	73	246	92
2	3.2	84	301	92
2 1/2	5.8	105	369	134
3	8.52	111	416	134

### Dimensional Drawing

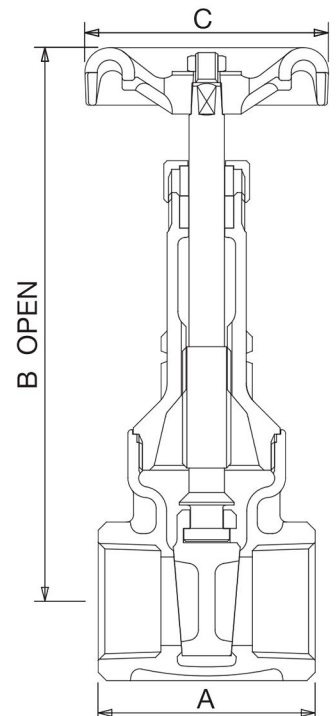

# GATE VALVES

## ZTN-015 SERIES

Brass Gate Valve  
Non rising stem

### Features & Benefits

- Bornic gate valves offer the ultimate in dependable service wherever minimum pressure drop is important
- Conforms with BS EN12288:2010 and generally conforms with MSS SP 80.

### Materials

PART NO	MATERIAL	SPECIFICATION	SIZES
Body	Brass	BS EN 1982 CC491K	All
Bonnet	Brass	BS EN 1982 CC491K	All
Stem	Brass	BS EN 1982 CC491K	1/4 - 2
Stem	Brass	BS EN 12164 CW602N	2 1/2 & 3
Disc	Brass	BS EN 1982 CC491K	All
Union Ring	Brass	BS EN 1982 CC491K	1/4 - 2 only
Packing	Asbestos Free	-	All
Gland	Brass	BS EN 12164 CW614N	All
Packing Nut	Brass	BS EN 12164 CW614N	1/4 - 2
Packing Nut	Brass	BS EN 1982 CC491K	2 1/2 & 3
Handwheel	Aluminium	-	1/4 - 2
Handwheel	Malleable Iron	BS EN 1562 GJMB-300-6	2 1/2 & 3
ID Plate	Aluminium	-	All
Handwheel Nut	Brass	BS EN 12164 CW614N	All
Stud	Steel	BS 970 070M20	2 1/2 & 3" only
Stud Nut	Steel	BS 4190 Gr.4	2 1/2 & 3" only
Gasket	Asbestos Free	-	2 1/2 & 3" only

### Dimensions & Weights

SIZE (inch)	WEIGHT (kg)	A (mm)	B (mm)	C (mm)
1/4	0.32	46	126	45
3/8	0.31	46	126	45
1/2	0.46	51	129	52
3/4	0.72	55	159	65
1	1.1	63	189	70
1 1/4	1.5	71	219	78
1 1/2	2.3	73	246	92
2	3.2	83	301	92
2 1/2	5.8	120	369	134
3	8.5	134	416	134

008



### Dimensional Drawing

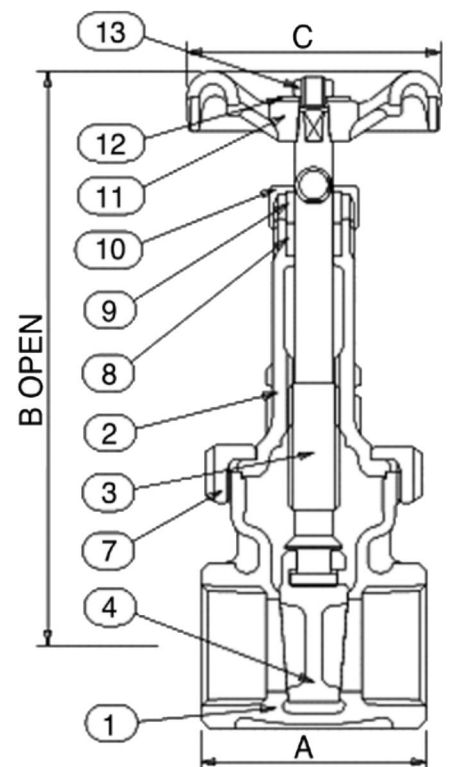

# GATE VALVES

## ZTN-015 SERIES

Brass Gate Valve  
Non rising stem

### Features & Benefits

The ZTN-015-009 brass gate valve offers a dependable and long service life across a wide variety of applications by virtue of its design and material composition.

- Non-rising stem design to minimise installation height
- Full bore design to ensure minimal pressure drop
- Adjustable gland packing for ease of maintenance
- Material selection results in superior dezincification and corrosion resistance properties
- Body, bonnet and disc are made from low lead content bronze, typically 4-6%

### Materials

PART NO	SPECIFICATION	SIZES
Body	Brass BS EN 1982 (CC491K)	All
Bonnet	Brass BS EN 1982 (CC491K)	All
Stem	Brass BS EN 12164 CW602N	All
Disc	Brass BS EN 1982 (CC491K)	All
Stem Retainer	Brass BS EN 12164 CW602N	All
Packing Ring	PTFE	All
Packing Gland	Brass BS EN 12164 CW614N	All
Lockshield	Brass BS EN 12164 CW614N	All
Lockshield Spanner	Mild Steel	All
Lockshield T-Bar	Mild Steel	All

009



### Dimensions & Weights

SIZE (inch)	WEIGHT (kg)	A (mm)	B (mm)	C (mm)	D (mm)	E (mm)
1/2	0.27	50	78	90	100	93
3/4	0.38	54	87	90	100	106
1	0.59	62	106	125	100	128
1 1/4	0.89	71	116	125	100	144
1 1/2	1.31	77.5	132	125	100	165
2	2.09	87.5	156	125	100	194

### Dimensional Drawing

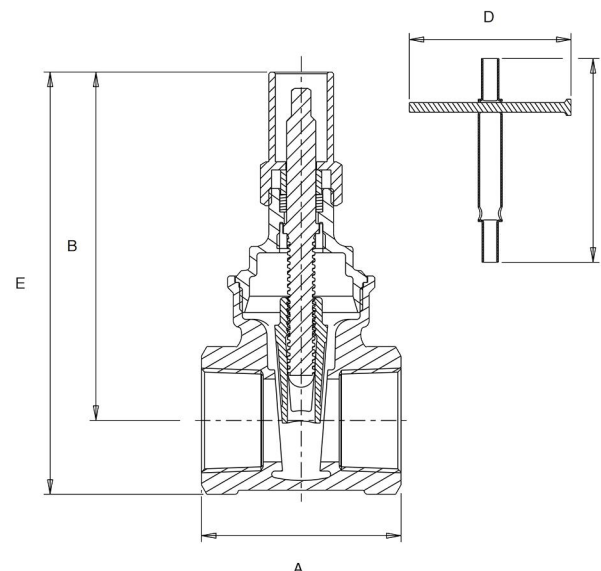

# GATE VALVES

## ZTN-015 SERIES

Brass Gate Valve  
Non rising stem

### Features & Benefits

- Bornic gate valves offer the ultimate in dependable service wherever minimum pressure drop is important
- Conforms with BS EN12288:2010 and generally conforms with MSS SP 80.

### Materials

PART NO	MATERIAL	SPECIFICATION	SIZES
Body	Brass	BS EN 12165 CW602N	All
Bonnet	Brass	BS EN 12165 CW602N	All
Stem	Brass	BS EN 12164 CW602N	All
Lockshield	Brass	BS EN 12165 CW614N	All
Packing	Asbestos Free	-	All
Stem Bush	Brass	BS EN 12164 CW602N	All
Disc	Brass	Brass BS EN 12165 CW602N	All

0010



### Dimensions & Weights

SIZE (inch)	WEIGHT (kg)	A (mm)	B (mm)
1/2	0.23	50	65
3/4	0.36	54	75
1	0.5	62	81
1 1/4	0.82	70	105
1 1/2	1.08	72	122
2	1.83	88	149

### Dimensional Drawing

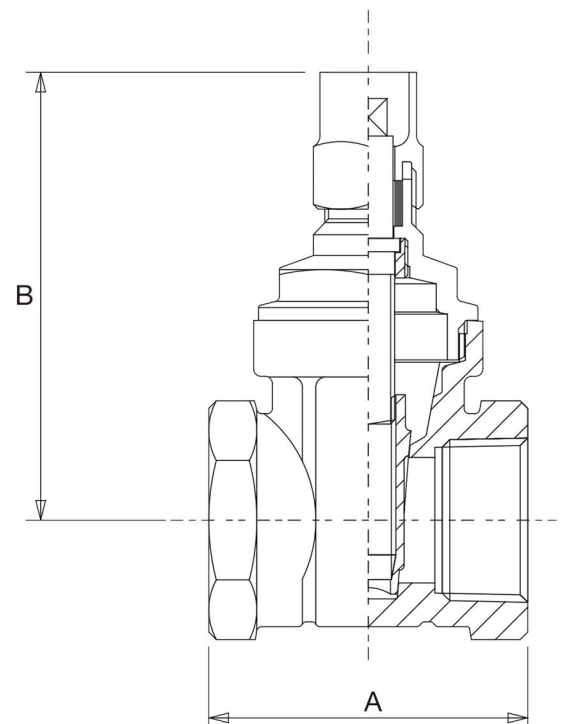

# Bornic Family of Brands

BORNIC(zhejiang Bornic Fluid ControlCo.,Ltd.)was established in 2005 in Yuhuan City,zhejiang Province. With 50 employees boasting nearly 20 years of industrial experience,our 5000-square-meterfacility strictly adheres to Iso quality management systems.

Our products hold EU CE,ACS,WARS,and CUPC certifications,ensuring quality and safety. With an annual output value of \$ 5 million USD, our insured products cater to global markets, adhering to European and other standards with customized services available.Specializing in premium brass fittings and valves,our innovative approach has garnered support in over 50 countries.



**Add:**TAIZHOU,ZHEJIANG PROVINCE,PR.CHINA

**Url:**[www.brasspushfit.com](http://www.brasspushfit.com)

**Emi:**[info@zjbornic.com](mailto:info@zjbornic.com)

**Tel:**+86-576-80735234